

**ADDENDUM NO. 2**

To the Plans and Specifications for:

**Blossom Lake Park Improvements**

City of Seminole

**1. BID DATE: NO CHANGE**

**Friday, January 21, 2022 @ 11:00 A.M.**

**2. TECHNICAL SPECIFICATIONS:**

**A. Bid Forms, Bid Tab, Schedule A**

Please note the following pay item name and quantity revisions:

- Pay Item A-D-4, TREE REMOVAL, PALM  
*Revise from 23 EA to 28 EA*
- Pay Item A-D-5 has been renamed.  
*Revise from 16 EA to 6 EA*
- Pay Item A-D-6 has been renamed.  
*Revise from 14 EA to 7 EA*
- Pay Item A-D-9, RELOCATE BENCH  
*Revise from 2 EA to 5 EA*

Schedule A has been reissued in its entirety.

**B. Exhibit B, Specifications, Section 01025 – Measurement & Payment**

Please note the following changes:

- Pay Item name changes have been made for A-D-5 & A-D-6
- Relocate Bench (ITEM A-D-9) description has been revised to remove reference to concrete slabs. Concrete slabs for reset benches shall be paid for using a separate pay item (ITEM A-S-1).
- Pay Item description for Tree Removal, Non-Palm < 13” DBH (ITEM A-D-5) and Tree Removal, Non-Palm > 13” DBH (ITEM A-D-6) has been revised to clarify how clustered trees are itemized.
- Concrete Slab, 6” (ITEM A-S-1) pay item description has been revised to clarify the need for fiber mesh reinforcement.

Section 01025, Measurement & Payment, has been reissued in its entirety

**3. PLANS:**

**A. Sheet C5, Site & Phasing Plan**

- a. Exercise Area 1 & 3 dimensions have been slightly revised to match the dimensions listed on Sheet C10 & C12.

**B. Sheet C7, Paving, Grading & Drainage Plan**

- a. Exercise Area 1 & 3 dimensions have been slightly revised to match the dimensions listed on Sheet C10 & C12.
- b. Corresponding spot elevation locations have been adjusted to account for new exercise area dimensions (Area 1 & 3 only).

**C. Sheet C9, General Details**

- a. Detail 2 – Park Bench Slab Detail
  - i. Slab thickness and reinforcement requirements have been revised.
- b. Detail 4 – Trail Typical Sections, Concrete Trail (Base Bid) / Concrete Trail with Tree Protection Measures
  - i. Expansion joint location requirement has been added to this typical section.

Sheets C5, C7 & C9 have been reissued.

**4. RESPONSE TO SUBMITTED QUESTIONS**

RSQ.1 Please confirm who is responsible for testing

*The Contractor shall be responsible for all testing required by the Contract Documents.*

RSQ.2 Please confirm who is responsible for paying for water.

*Water is considered an incidental material for construction. As such, the Contractor shall be responsible for paying for all water use charges.*

RSQ.3 Please comment on hydroseed establishment requirements.

*Please reference the pay item description for Hydroseed (ITEM A-S-12) to view establishment requirements associated with this pay item.*

RSQ.4 Please comment on the type of fencing required to delineate construction phases. Can this work be itemized separately?

*Please reference the Construction Phasing Plan notes on Sheet C5 to view phasing requirements. At a minimum, orange safety fencing (4') shall be used. The Contractor may use taller fencing and / or fencing of a different material with approval by the City to improve security & durability. Itemization of construction phasing fencing as a separate pay item is not proposed.*

*Modifications to this phasing plan may be presented by the Contractor. City approval shall be provided prior to implementing any revisions to the depicted phasing plan.*

5. **GENERAL CLARIFICATION / INFORMATION:**

GC.1 Please acknowledge all addenda on the Bid Form (Page 15).

GC.2 Addendum 1 included an anticipated schedule for contract award. The bid submission date was incorrectly noted. Please see the below for the anticipated contract award schedule with the corrected bid date.

Final Day for Questions	01/13/22
Addendum Issuance	01/18/22
Bid Submission	01/21/22
Council Award	02/08/22
Issue Notice to Proceed	04/11/22
Construction Completion (120 Day Duration)	08/09/22

GC.3 Please note that detectable warning surfaces will be required for the concrete sidewalk adjacent to Blossom Lake Drive and where the trail crosses the entrance drive. Per the measurement and payment section, cost for furnishing and installing detectable warning surfaces is to be paid for under the parent pay item.

GC.4 Construction of concrete crosswalk will require shutdown of the entrance drive. Contractor shall coordinate with City prior to performing this work so ample public messaging can be performed.

GC.5 The Contractor shall make note that heavy park usage may be experienced at the time when the adjacent elementary school is dismissed.

GC.6 The Contractor shall provide secure storage for all tools, hardware, etc. throughout the duration of the project. The City is not responsible for replacing any lost, damaged or stolen items stored on site.

CITY OF SEMINOLE

January 18, 2022

**Bid Tab  
Schedule A (Base Bid)**

*No changes shall be made to the Pay Item Quantities contained herein. Any corrections to bidders' entries shall be made in ink and shall be initialed by the bidder*

Pay Item No.	APPROXIMATE QUANTITIES	ITEM & UNIT PRICES BID (PRICES TO BE WRITTEN IN WORDS)	UNIT PRICE	AMOUNT
<b>Base Bid</b>				
A-G-1	1 Lump Sum	MOBILIZATION		
		Lump Sum	\$	\$
A-G-2	1 Lump Sum	MAINTENANCE OF TRAFFIC		
		Lump Sum	\$	\$
A-G-3	1 Lump Sum	EROSION & SEDIMENT CONTROL		
		Lump Sum	\$	\$
A-G-4	1 Lump Sum	CONSTRUCTION SURVEY, LAYOUT & RECORD DRAWINGS		
		Lump Sum	\$	\$
A-D-1	1 Lump Sum	CLEARING & GRUBBING		
		Lump Sum	\$	\$
A-D-2	60 Each	TREE PROTECTION, PALMS AND TREES 1" TO 8" DBH		
		Per Each	\$	\$
A-D-3	50 Each	TREE PROTECTION, TREES > 8" DBH		
		Per Each	\$	\$
A-D-4	28 Each	TREE REMOVAL, PALM		
		Per Each	\$	\$
A-D-5	6 Each	TREE REMOVAL, NON-PALM < 13" DBH		
		Per Each	\$	\$

**Bid Tab  
Schedule A (Base Bid)**

*No changes shall be made to the Pay Item Quantities contained herein. Any corrections to bidders' entries shall be made in ink and shall be initialed by the bidder*

Pay Item No.	APPROXIMATE QUANTITIES	ITEM & UNIT PRICES BID (PRICES TO BE WRITTEN IN WORDS)	UNIT PRICE	AMOUNT
<b>Base Bid</b>				
A-D-6	7 Each	TREE REMOVAL, NON-PALM > 13" DBH		
		Per Each	\$	\$
A-D-7	1 Lump Sum	ROOT PRUNING		
		Lump Sum	\$	\$
A-D-8	40 Hours	ARBORIST CONSULTANT		
		Per Hour		\$
A-D-9	5 Each	RELOCATE BENCH		
		Per Each		\$
A-D-10	1 Each	RELOCATE GRILL		
		Per Each		\$
A-D-11	12 Each	RELOCATE SIGN, PET STATIONS		
		Per Each		\$
A-D-12	1,250 Square Yards	REMOVE TRAIL PAVEMENT		
		Per Square Yard		\$
A-D-13	50 Cubic Yards	UNSUITABLE MATERIAL, REMOVE & REPLACE		
		Per Cubic Yard		\$
A-S-1	175 Square Yards	CONCRETE SLAB, 6"		
		Per Square Yard		\$

**Bid Tab**  
**Schedule A (Base Bid)**

*No changes shall be made to the Pay Item Quantities contained herein. Any corrections to bidders' entries shall be made in ink and shall be initialed by the bidder*

Pay Item No.	APPROXIMATE QUANTITIES	ITEM & UNIT PRICES BID (PRICES TO BE WRITTEN IN WORDS)	UNIT PRICE	AMOUNT
<b>Base Bid</b>				
A-S-2	45 Square Yards	CONCRETE SIDEWALK, 4"		
		Per Square Yard		\$
A-S-3	135 Square Yards	CONCRETE SLAB, 6" WITH THICKENED EDGES		
		Per Square Yard		\$
A-S-4	1 Lump Sum	FENCE OPENING MODIFICATIONS		
		Lump Sum		\$
A-S-5	1 Lump Sum	POND MODIFICATIONS		
		Lump Sum		\$
A-S-6	3,375 Square Yards	TRAIL, CONCRETE		
		Per Square Yard		\$
A-S-7	335 Square Yards	TRAIL, CONCRETE, TREE PROTECTION MEASURES		
		Per Square Yard		\$
A-S-8	50 Cubic Yards	TRAIL, ADDITIONAL ROCK BASE		
		Per Cubic Yard		\$
A-S-9	20 Each	TRAIL, HINGED SHEAR KEY		
		Per Each		\$
A-S-10	9,700 Square Yards	TRANSITION GRADING		
		Per Square Yard		\$

**Bid Tab**  
**Schedule A (Base Bid)**

*No changes shall be made to the Pay Item Quantities contained herein. Any corrections to bidders' entries shall be made in ink and shall be initialed by the bidder*

Pay Item No.	APPROXIMATE QUANTITIES	ITEM & UNIT PRICES BID (PRICES TO BE WRITTEN IN WORDS)	UNIT PRICE	AMOUNT
<b>Base Bid</b>				
A-S-11	1 Lump Sum	CROSSWALK & PARKING STALL STRIPING		
		Lump Sum		\$
A-S-12	9,650 Square Yards	HYDROSEED		
		Per Square Yard		\$
A-S-13	1 Lump Sum	EXERCISE EQUIPMENT ASSEMBLY & INSTALLATION, AREA 1		
		Lump Sum		\$
A-S-14	1 Lump Sum	EXERCISE EQUIPMENT ASSEMBLY & INSTALLATION, AREA 2		
		Lump Sum		\$
A-S-15	1 Lump Sum	EXERCISE EQUIPMENT ASSEMBLY & INSTALLATION, AREA 3		
		Lump Sum		\$
A-S-16	10 Each	CONCRETE BUMPER GUARD		
		Per Each		\$
<b>TOTAL (SCHEDULE A)</b> _____ _____ _____				\$ _____

## **Section 01025 Measurement & Payment**

### **Part 1 General**

#### **1.01 Scope of Payment**

Payment to the CONTRACTOR will be made for actual quantities and work completed and accepted in accordance with the Contract.

The CONTRACTOR shall accept in compensation provided herein full payment for furnishing all materials, labor, tools, equipment, and incidentals necessary to complete all work included in the Contract; also for all loss or damage arising from the nature of the work, inclement weather, action of the elements or from any unforeseen difficulties which may be encountered during the execution of the work or except as provided herein. The CITY will make no allowances for items not included in the proposal.

#### **1.02 Procedure for Measurement**

- A. For lump sum items, payment shall be based on the lump sum prices set forth in the Bid Proposal and based on the amount of completed work.
- B. For field measured unit-price items, payment shall be based on the actual amount of work accepted and the actual amount of materials in place, as will be determined by measurements.

#### **1.03 Estimated Quantities**

All estimated field measure quantities stipulated in the Contract Documents are approximate and are to be used only (a) as a basis for estimating the probable cost of the WORK and (b) for purpose of comparing the bids submitted for the WORK. The actual amounts of WORK done under field measured unit price items may differ from the estimated quantities. The basis of payment for WORK will be the actual amount of WORK performed and field measured.

Should the quantities of unit price items listed in the original Vendor Proposal Form increase or decrease, the prices for these items must be at the unit price quoted by the CONTRACTOR on his original Vendor Proposal Form.

#### **1.04 Incidental Work**

All work shown on the plans and referenced in the specifications as being part of the contract for which no separate pay item is provided is considered incidental to the contract. Incidental items are to be incorporated into the pay items provided. Claims for separate payment of incidental items will not be considered.

#### **1.05 Items Included but Not Specified**

The unit or lump sum prices designated in the Bid Proposal shall include all profit, taxes, labor, overhead, material, equipment, tools, utility notification and coordination, protection of existing utilities, temporary support of existing utilities, irrigation protection / demolition & repair, shoring (proprietary & non-proprietary), sheeting and slope protection (proprietary & non-proprietary), night work when needed, design of sheeting/shoring/slope stabilization, backfill, dewatering, extra backfill material as required, excavation materials, protection and preservation of existing



structures, salvaging of items as shown on the drawings, coordination with City staff and residents, the erection of previously removed fencing and gates, securing a Building Permit and other work incidental thereto and specified in these specifications and on the drawings.

**1.06 Description of Pay Items**

The following describes the measurement of and payment for the work to be done under the respective items listed in the Bid Proposal.

Each field measure unit or lump sum item stated in the Bid Proposal shall constitute full compensation for each item of work completed.

**Mobilization (ITEM A-G-1)**

The work specified under this Section consists of preparatory work and operation in mobilizing to begin work on the project, including but limited to those operations necessary for the movement of personnel, equipment, supplies and incidentals to the project site(s), and for the establishment of temporary offices, buildings, safety equipment, project sign and first aid supplies, sanitary and other facilities as required by these specifications, special provisions, and state and local laws and regulations. Mobilization costs shall also include the costs of preconstruction videotaping, coordination with residents throughout the project's duration, coordination with City representatives throughout the project's duration, project signs, insurance, bonds, permits (including NPDES and dewatering) and other Contract materials.

The contract unit price will be on a lump sum (LS) unit price. Partial payments will be allowed as outlined below.

PERCENT OF ORIGINAL CONTRACT AMOUNT EARNED	ALLOWABLE PERCENT OF THE LUMP SUM PRICE FOR MOBILIZATION (*)
5	25
10	50
25	75
100	100

**Maintenance of Traffic (ITEM A-G-2)**

This Section consists of the maintaining vehicular and pedestrian traffic within limits of the project for the duration of the construction period, in accordance with the requirements of FDOT Section 102 of the "Standard Specifications", as amended herein.

The Contractor will not be permitted to close access to residences or places of business. Provisions shall be made to provide access to large trucks for pick-up and delivery of materials during the construction period. The Contractor shall furnish, erect, and maintain all necessary traffic control and safety devices, in accordance with the Florida Department of Transportation "ROADWAY AND TRAFFIC DESIGN STANDARDS", applicable edition, and State of Florida's "MANUAL OF TRAFFIC CONTROL AND SAFE PRACTICES FOR STREET AND HIGHWAY CONSTRUCTION MAINTENANCE AND UTILITY OPERATIONS", applicable edition, and shall take all necessary precautions for the protection of the work and the safety of the public for duration of the construction period.

A Maintenance of Traffic (MOT) plan shall be submitted to the City, by the Contractor, and approved prior to implementation. This plan shall include all necessary signage and dimensions and be prepared by an Advanced MOT certified party or Florida-registered professional engineer.

The work specified under this Section shall include the furnishing, erection, and maintenance of all temporary traffic barricades of whatever type required, and for such duration as may be required, and shall include all materials and construction necessary for temporary connections and driveway maintenance. The Contract unit price for this item will be a lump sum unit price. Partial payments for maintenance of traffic will be limited to the overall percent of the work completed by the Contractor.

This pay item shall include multiple setups and modifications, as needed, to satisfactorily perform the work.

This pay item shall include the construction and demolition of ADA-compliant temporary walking surfaces where required to maintain pedestrian access.

**Erosion & Sediment Control (ITEM A-G-3)**

Price shall include payment for all installation, maintenance, removal, and all other incidentals necessary to provide erosion and sediment control (within the project boundaries) as notated on the plans and as required by any local, state or Federal code, statute or ordinance. Daily debris removal from right of ways, easements and vehicle use areas shall be included in this pay item.

Payment for this item shall be on a lump sum (LS) basis and shall include all necessary equipment, labor and materials to complete this pay item. The Contractor shall receive compensation for this item as stipulated in the below table.

PERCENT OF ORIGINAL CONTRACT AMOUNT EARNED	ALLOWABLE PERCENT OF THE LUMP SUM PRICE FOR EROSION AND SEDIMENT CONTROL
5	25
10	50
25	75
100	100

**Construction Survey, Layout & Record Drawings (ITEM A-G-4)**

Payment for construction survey, layout and record drawing preparation will be paid for on a lump sum basis. The price paid shall be payment in full for identifying existing elevations, identifying proposed elevations, layout of proposed features, coordination with the City and Engineer, duplicate survey and layout if revisions are proposed and all other incidentals necessary to complete this item. The preparation of record drawings shall also be a component of this pay item.

Measurement for payment shall be Lump Sum (LS) with partial payments based on the overall percent of the work completed by the Contractor.

### **Clearing and Grubbing (ITEM A-D-1)**

Payment for Clearing and Grubbing shall include all equipment, labor and materials necessary to prepare the site for the proposed improvements. Work activities to be covered under this pay item shall include, but not be limited to clearing and grubbing, demolition where called for within the plans (asphalt parking stalls including perimeter curbing, concrete trail crossing, etc.), utilizing crushed concrete to backfill locations where concrete parking stalls were demolished, protection of existing features, adjusting surficial features, compaction, dewatering, testing and all other incidentals necessary to complete this item.

Hand clearing and grubbing, where required, shall be a component of this pay item.

Payment for Clearing and Grubbing shall be made on a lump sum (LS) basis.

### **Tree Protection, Palms and Trees 1" to 8" DBH (ITEM A-D-2)**

#### **Tree Protection, Trees > 8" DBH (ITEM A-D-3)**

Payment for Tree Protection shall include furnishing, installing and removing tree protection around trees near construction activities where required and as indicated on the construction plans for the specific tree type and size (DBH), and removal upon completion. Tree Clusters larger than 8" at DBH that require protection shall be included in Item A-D-3.

Payment for tree protection shall be made on a per each (EA) basis for the type and size tree protected.

#### **Tree Removal, Palm (ITEM A-D-4)**

#### **Tree Removal, Non-Palm < 13" DBH (ITEM A-D-5)**

#### **Tree Removal, Non-Palm > 13" DBH (ITEM A-D-6)**

Payment for Tree Removal shall include removing trees in conflict with construction activities as identified on the drawings, for the specific tree type and size (DBH). Removal shall include 100% of the crown and trunk. The stump and root system shall be removed at least 2 ft. below grade. Holes created by removed stumps and root systems shall be filled with clean soil and compacted to match existing grade.

For clustered trees that share the same root ball, add DBHs to determine tree overall size. For aggregate DBHs less than 13", use Pay Item A-D-5. For aggregate DBHs greater than 13", use Pay Item A-D-6

Payment shall be made per each (EA) tree removed based on type and size.

### **Root Pruning (ITEM A-D-7)**

Payment for root pruning shall be made a lump sum (LS) basis. Payment shall include, but not be limited to, the following: coordination with certified arborist, performing root pruning in accordance with plan requirements, protection of roots until final backfill and all other incidentals required to successfully perform the work.

It shall be noted that this pay item is only applicable for locations where tree protection measures for the trail are not required.

**Arborist Consultant (ITEM A-D-8)**

Payment for Arborist Consultant shall be for an independent ISA Certified Arborist consultant to provide consultation and inspection when tree protection measures are required for the proposed trail. The Arborist Consultant shall be approved by City.

Payment for Arborist Consultant shall be per Hour (HR) based on time onsite, either when requested by City or Contractor. Maximum of 40 hours shall not be exceeded unless approved in writing by the City prior to exceeding the hour threshold.

**Relocate Bench (ITEM A-D-9)**

**Relocate Grill (ITEM A-D-10)**

**Relocate Sign, Pet Station (ITEM A-D-11)**

Payment for relocating existing park facilities identified above and as shown on the construction drawings shall be for removing, moving, and, re-installing facilities including removal of unsuitable materials, placement of fill material, excavation, grading and leveling area, setting posts in concrete, dis- and re-assembling facilities, new brackets and fasteners as needed, anchors, touch up painting, filling holes and grading disturbed areas.

Measurement for payment shall be for Each (EA) of the types of existing park facilities relocated and accepted.

**Remove Trail Pavement (ITEM A-D-12)**

The above pay item shall include payment for removing and properly disposing of existing paved trail in accordance with the plans. Work shall include, but not be limited to, the following: trail and base removal and disposal to the depth called for on the plans, furnishing and installing clean fill where base and trail has been removed, protection of features proposed to remain, grading, as needed to achieve pre-demolition site elevations and all other incidentals necessary to complete this item.

Measurement for payment for this item shall be per Square Yard (SY) of field measured existing trail pavement removed and properly disposed.

**Unsuitable Material, Remove & Replace (ITEM A-D-13)**

The above pay item shall include payment for removing (from the site) and properly disposing of material deemed unsuitable for use. Work activities to be covered under this pay item shall include, but not be limited to, the following: coordination with City staff, quantity tracking using a City-approved approach, material testing to confirm suitability of existing site material, excavation, sheeting/shoring/slope protection, separation of suitable and unsuitable material, removal of rocks/boulders/debris from unsuitable material, dewatering of excavated material, temporary storage of material to be onsite, all trucking and transportation costs, furnishing and installing suitable material and all other incidentals necessary to complete this item. Payment for this item shall be on a per cubic yard of unsuitable material excavated, removed, disposed and replaced basis and shall include all necessary equipment, labor and materials to complete this pay item.

It shall be noted that this pay item is only applicable for the removal of material which currently is onsite. Any unsuitable material imported by the Contractor shall be removed (and disposed of) at no additional cost to the City. Written approval from the City/Engineer shall be provided prior to utilization of this pay item.

Measurement for payment for this item shall be per Cubic Yard (CY) of field measurement of volume per truck load or container of material removed and disposed.

**Concrete Slab, 6" (ITEM A-S-1)**

**Concrete Sidewalk, 4" (ITEM A-S-2)**

**Concrete Slab, 6" with Thickened Edges (ITEM A-S-3)**

Payment for concrete slabs and sidewalks shall be made on a per Square Yard (SY) basis and shall include all material, equipment and labor to complete the work. Work shall include, but not be limited to, the following: dewatering, excavation, foundation preparation, placement of fill material, grading as needed to achieve plan-specified elevations and slopes, compaction, form work, reinforcement, screeding, floating, jointing, finishing, detectable warning surface installation, protection against adverse weather conditions, dirt access drive / parking restoration, equipment, labor, finishing, material testing and all other incidentals necessary to complete this item.

All concrete installed under ITEM A-S-1 (Concrete Slab, 6") shall utilize fiber mesh reinforcement.

**Fence Opening Modifications (ITEM A-S-4)**

This pay item shall be payment for installing openings in existing entrance fences to accommodate new trails by removing old fence and installing new fence including removing posts, cutting mesh, rails, installing new end and line posts w/concrete embedment, mesh, rails, connecting to new end posts to existing fence; brackets and fasteners. Also includes removal and reinstallation of existing gate stop if in conflict.

Payment shall be made on a Lump Sum (LS) basis for all entrance fence modifications proposed within the plans.

**Pond Modifications (ITEM A-S-5)**

This Pay Item shall include payment for reshaping the existing pond including new liner material as shown on the construction plans or as otherwise required to achieve the plan specified grades. Work activities to be covered under this Pay Item shall include dewatering, excavation of pond expansion area, removal and disposal of existing liner in reshaped pond areas, coordination with City who will extend pipe and install new mitered end sections, furnishing and installing clean fill, compaction of filled soils, grading pond bottoms and slopes; installing new liner including attaching new liner to existing liner in accordance with manufacturer's recommendations, testing liner seams, covering new liner with soil to specified depths, burying ends of liner, finish grading; and all labor and all incidentals necessary to complete this pay item. Payment for shall be made on a Lump Sum (LS) basis.

**Trail, Concrete (ITEM A-S-6)**  
**Trail, Asphalt (ITEM B-S-6)**  
**Trail, Flexible Porous Pavement (ITEM C-S-6)**

The above pay item shall include payment for constructing a recreational trail in accordance with the requirement set forth within the plans. Work activities to be covered under this pay item shall include, but not be limited to, the following: dewatering, excavation, foundation preparation (varies per trail material), furnishing and installation clean fill where needed to achieve plan elevations, removal and proper disposal of excess material where needed to achieve plan elevations, trail construction in accordance with plan and specification requirements, protection of completed work, furnishing and installing detectable warning surfaces, material testing and all other incidentals necessary to complete this item.

Measurement for payment for these Pay Items shall be at the Contract unit price per Square Yard (SY), based on field measurements, completed and accepted.

**Trail, Concrete, Tree Protection Measures (ITEM A-S-7)**

The above pay item shall include payment for constructing a concrete trail utilizing the tree protection measures outlined within the plans and specifications. Work activities to be covered under this pay item shall include, but not be limited to, the following: furnishing and installation clean fill where needed to achieve plan elevations, removal and proper disposal of excess material where needed to achieve plan elevations, delineation of trail limits where tree protection measures are to be utilized, dewatering, certified arborist coordination, exposing roots using air spading to the specified depth, protection of exposed roots prior to backfill, critical root determination, critical root mapping per plan requirements where required, layout revisions as provided by the Engineer, supplemental import and / or export of clean fill where needed to achieve revised elevations, foundation preparation per plan requirements, concrete trail construction per plan requirements, protection of completed work, material testing and all other incidentals necessary to complete this item.

Payment shall be made on a per Square Yard (SY) of concrete trail constructed utilizing tree protection measures.

**Trail, Additional Rock Base (ITEM A-S-8)**

The above pay item shall include payment for supplying additional rock base where the presence of a critical root requires adjustments to the plan-specified trail elevations. It shall be noted that payment will only be provided for rock base constructed in addition to the 6" thickness shown on the plans. The Contractor may not utilize this pay item without written approval from the City.

Payment shall be made on a per Cubic Yard (CY) of additional rock base furnished and installed for the concrete trail.

**Trail, Hinged Shear Key (ITEM A-S-9)**

The above pay item shall include payment for furnishing and installing hinged shear keys when required by the Engineer or City to mitigate for a critical root. The Contractor may not utilize this pay item without written approval from the City.

Payment shall be made on a per Each (EA) shear key installed along the entire width of the trail.

### **Transition Grading (ITEM A-S-10)**

The above pay item shall include payment for performing transition grading as needed to suitably transition between proposed and existing elevations. Payment shall include, but not be limited to, the following: furnishing and installation clean fill where needed to achieve plan elevations, removal and proper disposal of excess material where needed to achieve plan elevations, defining grading limits using slope criteria identified within the plans, excavation, dewatering, grading, compaction, material testing and all other incidentals necessary to complete this item.

Payment shall be made per Square Yard (SY) of grassed area graded to per plan requirements. Grading associated with other surfaces (trail, slabs, sidewalks, etc.) shall be paid for under the parent pay item.

### **Crosswalk & Parking Stall Striping (ITEM A-S-11)**

Payment for this Pay Item includes all equipment, material and labor needed to stripe concrete surfaces for pedestrian or parking activities. Work shall include surface preparation, striping layout, painting of crosswalk and parking stall markings and symbols in accordance with plan requirements, painting of contrast lines, protection of work and other incidentals necessary to complete this item.

Payment shall be made on a Lump Sum (LS) basis for all striping improvements proposed within the plans.

### **Hydroseed (ITEM A-S-12)**

Payment shall be in for furnishing and installing hydroseed, topsoil, all necessary subgrade preparation, grading, fertilizing, watering, mowing, maintenance, care, and replacement of defective hydroseed and surplus materials.

Measurement for payment will be field measured Square Yard (SY) of hydroseed installed on all disturbed work areas within the limits of construction as shown on drawings and/or directed in the field by the City. Payment for hydroseed will not be made for disturbed areas outside the limits of construction, including equipment and material storage areas. Restoration in these areas shall be at the Contractor's expense.

The Contractor shall protect and water newly seeded areas until turf is established. See FDOT Specification Section 570 for establishment definition. Protection may require the installation of temporary construction fencing until establishment.

### **Exercise Equipment Assembly & Installation, Area 1 (ITEM A-S-13)**

### **Exercise Equipment Assembly & Installation, Area 2 (ITEM A-S-14)**

### **Exercise Equipment Assembly & Installation, Area 3 (ITEM A-S-15)**

Payment for this Pay Item includes all equipment, material and labor needed to assemble and install exercise equipment within the associated exercise area. Payment shall include, but not be limited to, the following: manufacturer coordination, furnishing and installing all materials required for installation, safe transport from the Recreation Dept. to the project site, assembly of equipment in accordance with manufacturer recommendations, exercise area layout, equipment

installation, protection of equipment, finishing and any other incidentals necessary to complete this item.

Payment shall be made on a Lump Sum (LS) basis for each exercise area assembled.

**Concrete Bumper Guard (ITEM A-S-16)**

Payment for this Pay Item includes all equipment, material and labor needed to furnish and install concrete bumper guards in accordance with FDOT Standard Plan Index 520-001. Payment shall include, but not limited to, the following: furnishing concrete bumper guards, parking configuration layout, placing and pinning of concrete bumper guards and any other incidentals necessary to complete this item.

Payment shall be made on a per each (EA) basis for each concrete bumper guard furnished and installed.

**End of Section**



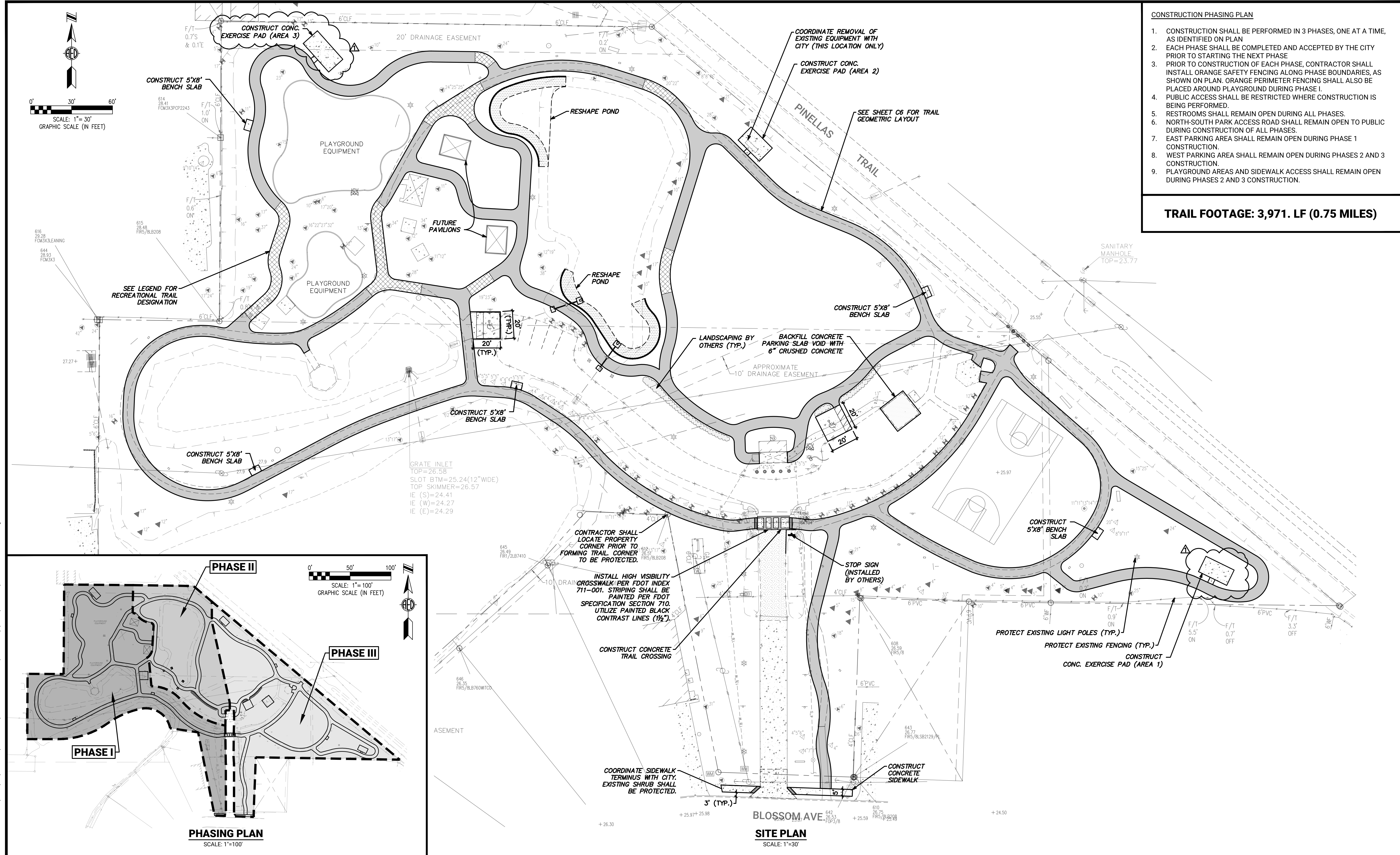

Date: 10/27/06 Time: 9:18 AM Filename: M:\Municipal\Seminoles\21.SEM-15 (Blossom Lake Park Improvements)\Code\Current\SEM-15\_CS\_AddNo2.dwg

NO.	REVISIONS	BY	DATE
1	ADDENDUM NO. 2	WGR	1/18/22

SCALE:	AS SHOWN
DRAWN:	S.A.T.
DESIGNED:	J.V.K.
APPROVED:	W.G.R.

**ADVANCED**  
ENGINEERING & DESIGN, INC.  
CIVIL • MUNICIPAL • SITE DESIGN • PERMITTING • PLANNING  
3931 68TH AVENUE NORTH • PINELLAS PARK, FL 33781 • Phone: 727.526.9158 • Fax: 727.527.9683

**CITY OF SEMINOLE**  
**BLOSSOM LAKE PARK IMPROVEMENTS**

**SITE & PHASING PLAN**

DATE: 12/14/2021  
PROJECT NO: 21.SEM-15  
SHEET NO: **C5**

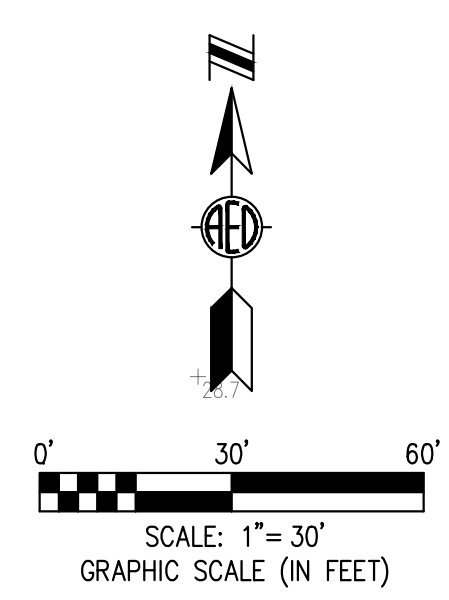

- NOTE:**
1. HYDROSEED ALL DISTURBED AREAS WITHIN GRADING LIMITS.
  2. POND RESHAPING SHALL INCLUDE REMOVAL OF OLD LINER IN CUT AREAS.
  3. NEW PVC LINER SHALL BE INSTALLED IN POND CUT AREAS AND SEALED TO EXISTING LINER.
  4. POND BANK SHALL BE PERPENDICULAR TO M.E.S.
  5. CONTRACTOR SHALL COORDINATE POND WORK WITH CITY INSTALLATION OF NEW M.E.S. & 16" PIPE EXTENSIONS.
  6. CONTRACTOR SHALL INTERPOLATE TRAIL ELEVATIONS BETWEEN SPOT GRADES PROVIDED ON THE PLAN. SEE DETAIL ON THIS SHEET FOR CROSS SLOPE TRANSITION REQUIREMENTS.

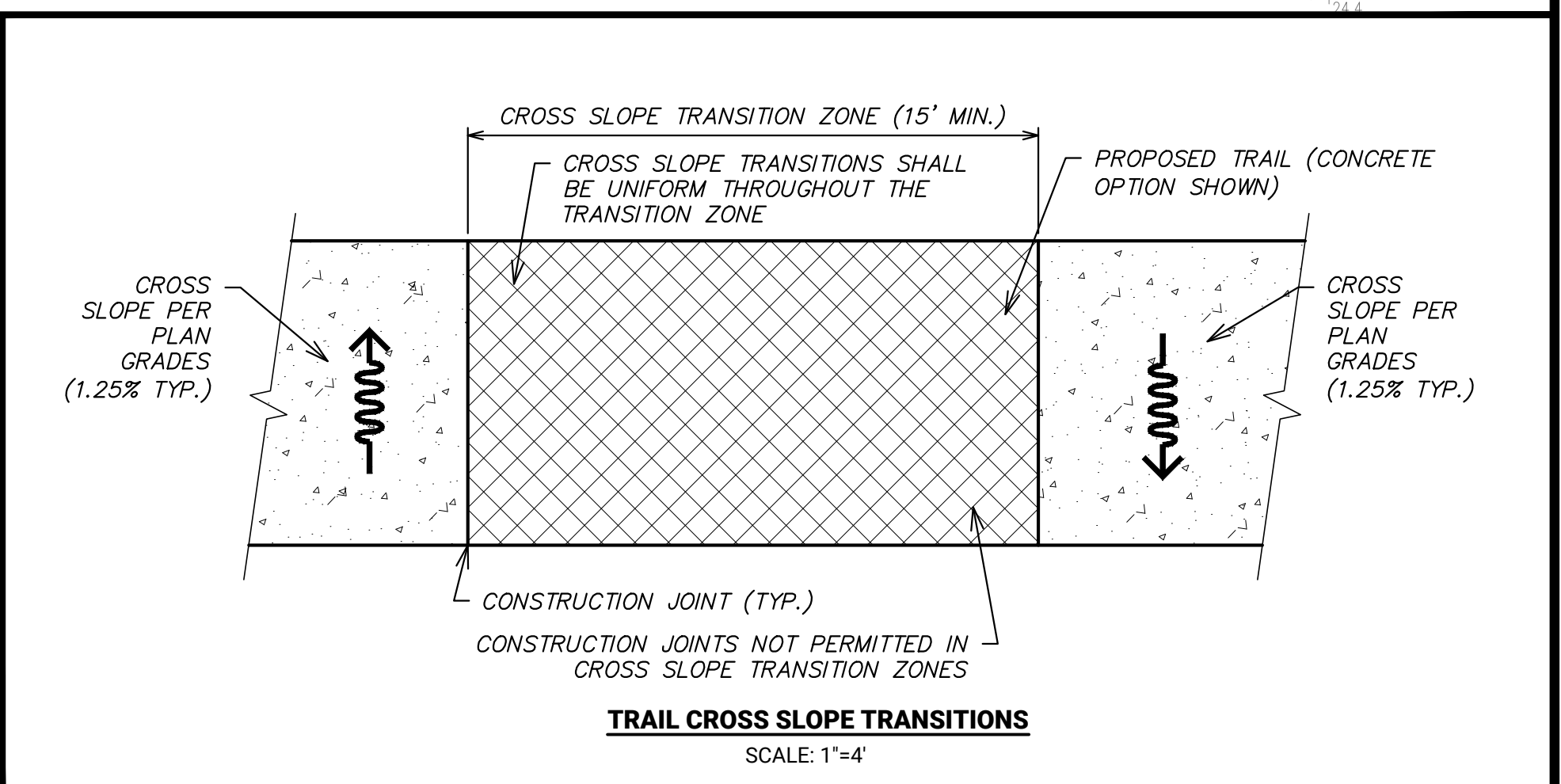
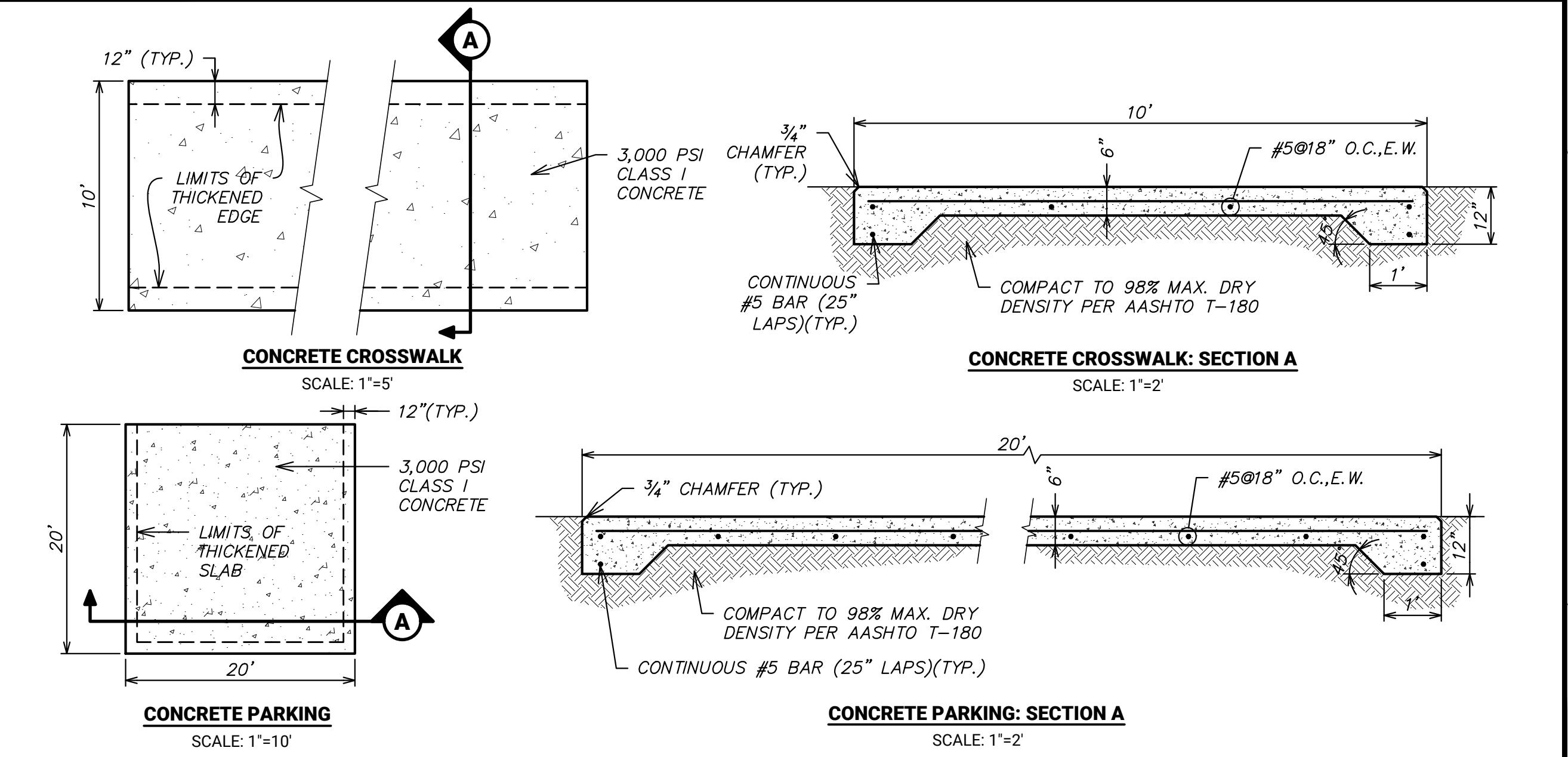
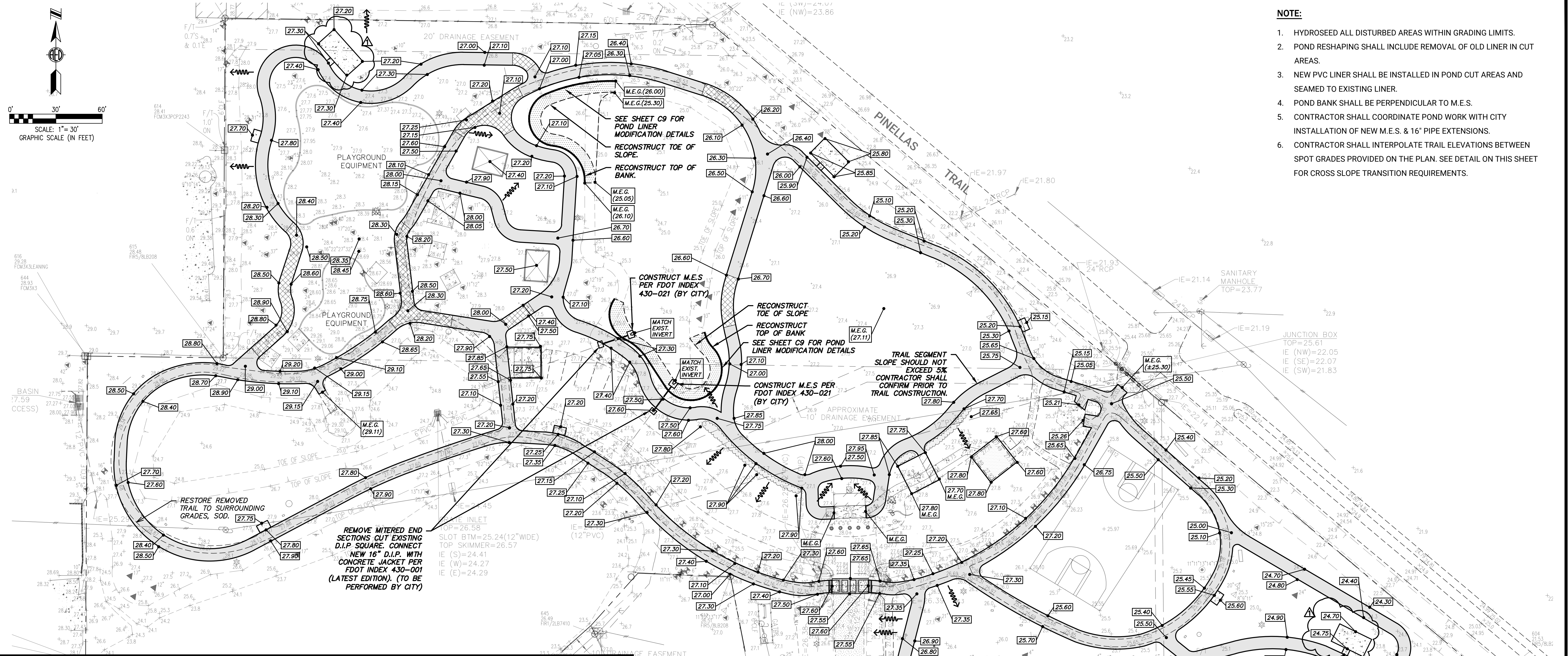

Date: 10/27/06 Time: 9:18 AM Filename: M:\Municipal\Seminoles\21.SEM-15 (Blossom Lake Park Improvements)\Code\Current\SEM-15\_C7\_AvdNo2.dwg

NO.	REVISIONS	BY	DATE
1	ADDENDUM NO. 2	WGR	1/18/22

SCALE:	AS SHOWN
DRAWN:	S.A.T.
DESIGNED:	J.V.K.
APPROVED:	W.G.R.

**ADVANCED**  
ENGINEERING & DESIGN, INC.  
CIVIL • MUNICIPAL • SITE DESIGN • PERMITTING • PLANNING  
3931 68TH AVENUE NORTH • PINELLAS PARK, FL 33781 • Phone: 727.526.9158 • Fax: 727.527.9683

**CITY OF SEMINOLE**  
**BLOSSOM LAKE PARK IMPROVEMENTS**

**PAVING, GRADING & DRAINAGE PLAN**

DATE:	12/14/2021
PROJECT NO.:	21.SEM-15
SHEET NO.:	<b>C7</b>

Date: 10/27/06 Time: 9:18 AM Filename: M:\Municipal\Seminoles\21.SEM-15 (Blossom Lake Park Improvements)\Code\Current\SEM-15\_CB-C13\_Adv2.dwg

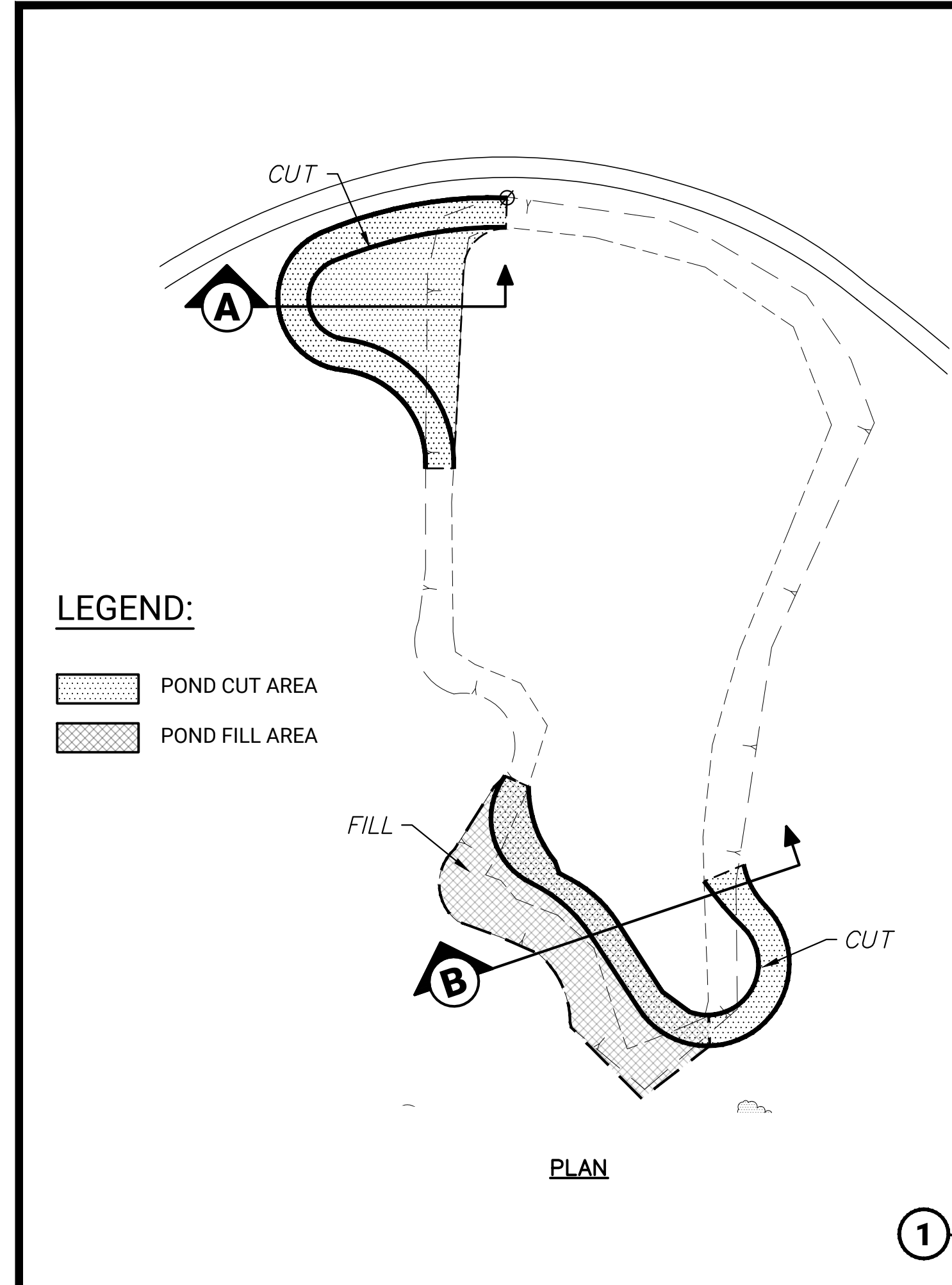

**1 POND LINER DETAIL**  
NOT TO SCALE

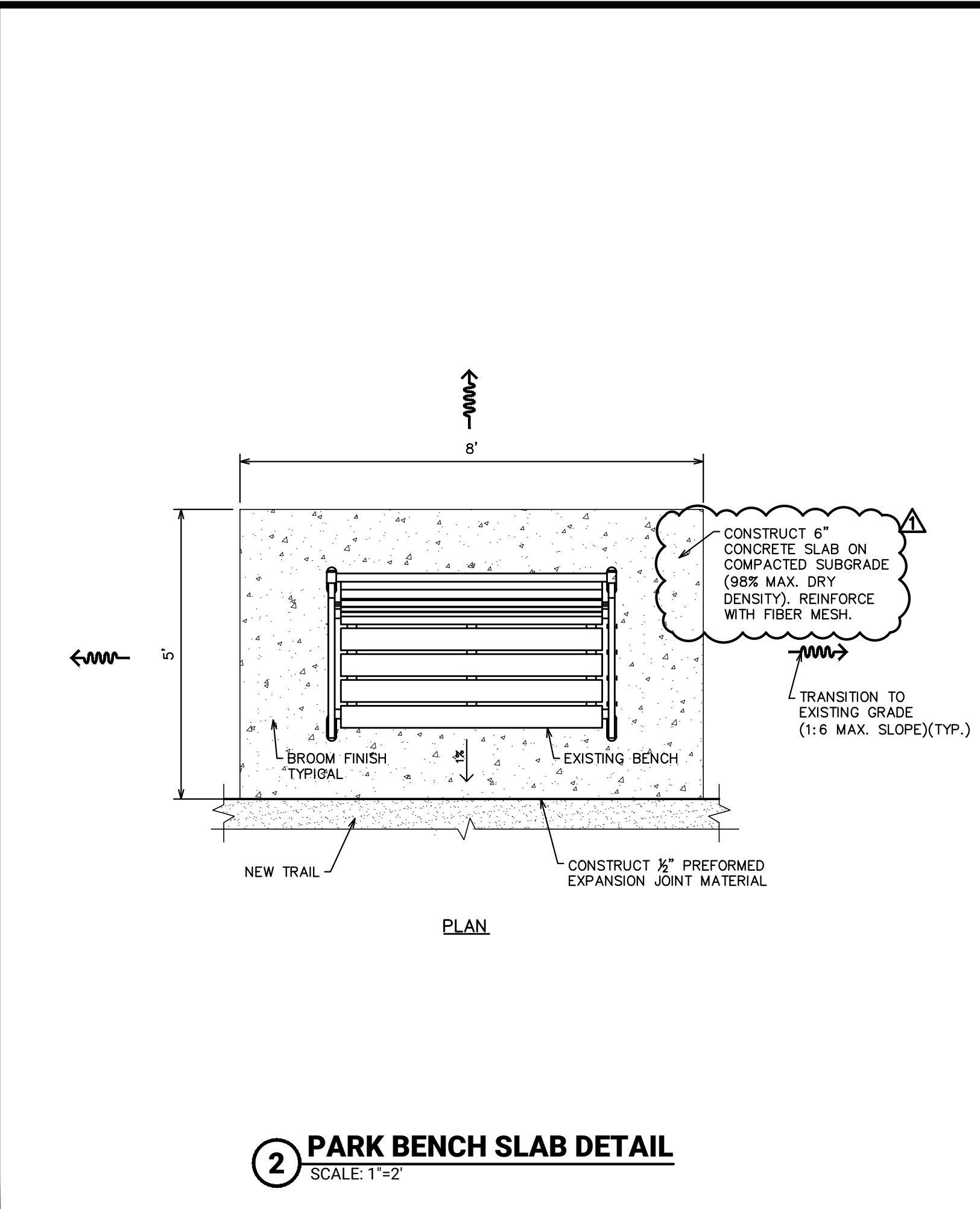

**2 PARK BENCH SLAB DETAIL**  
SCALE: 1"=2'

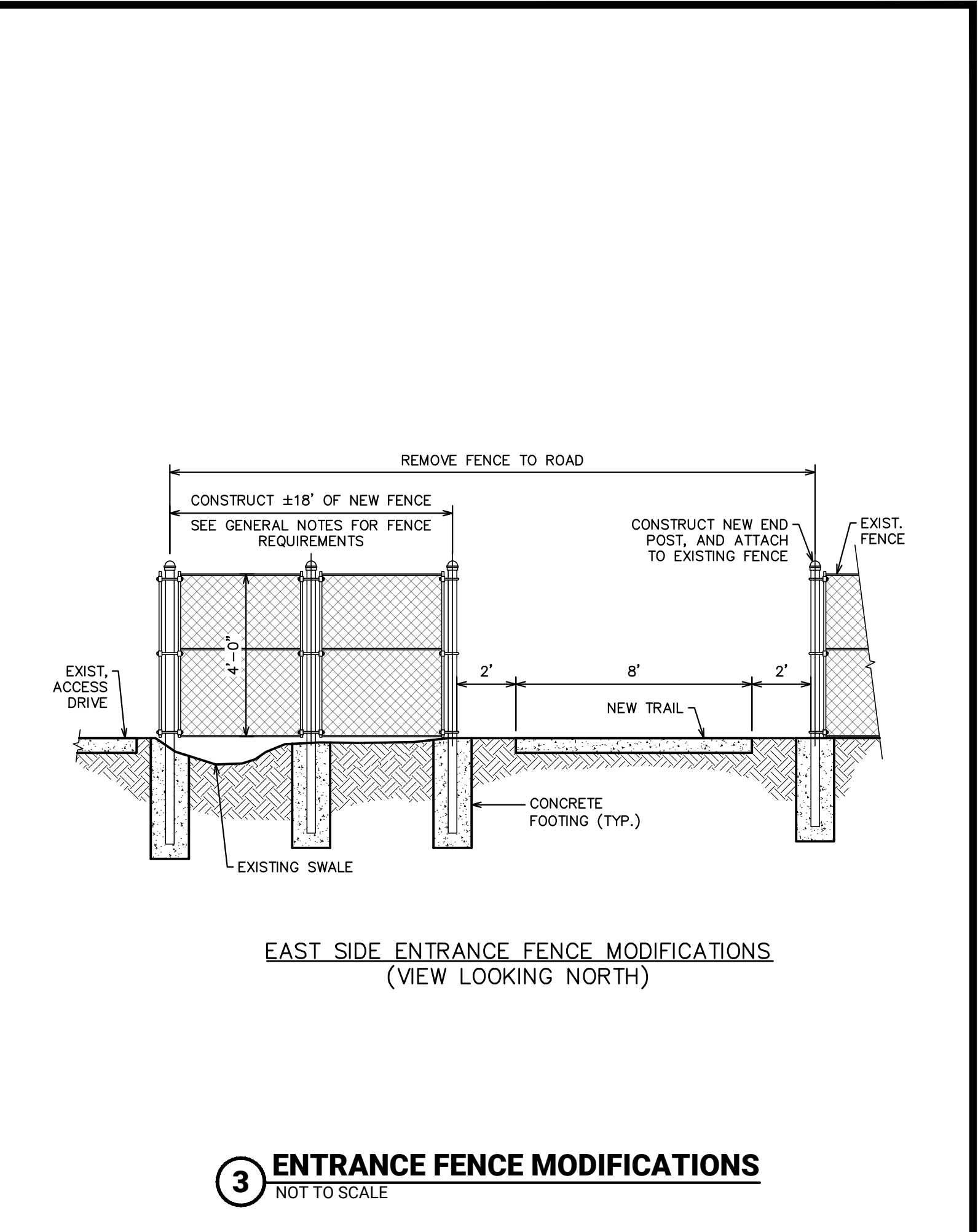

**3 ENTRANCE FENCE MODIFICATIONS**  
NOT TO SCALE

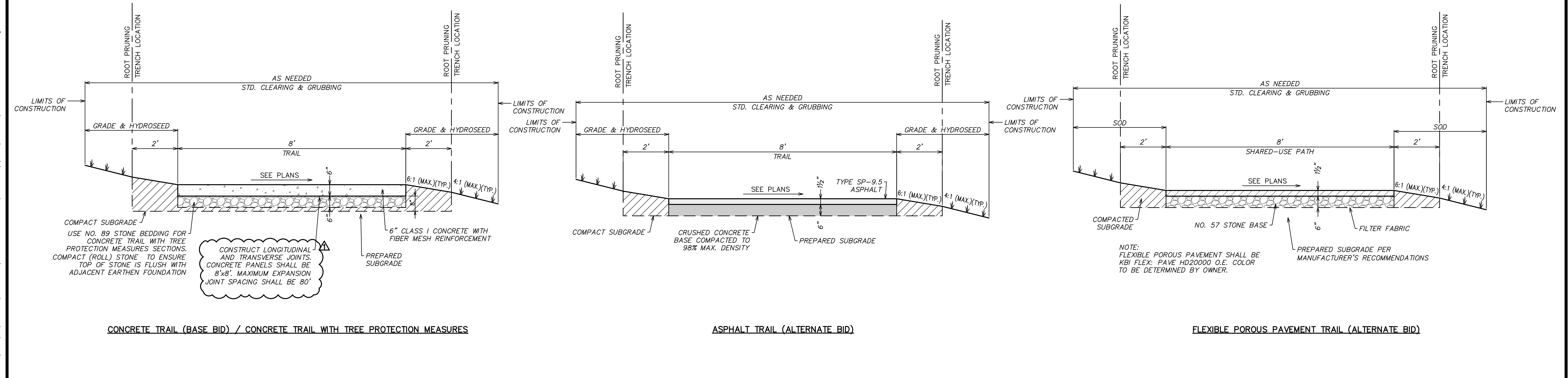

**4 TRAIL TYPICAL SECTIONS**  
NOT TO SCALE

NO.	REVISIONS	BY	DATE
1	ADDENDUM NO. 2	WGR	1/18/22

SCALE:	AS SHOWN
DRAWN:	S.A.T.
DESIGNED:	J.V.K.
APPROVED:	W.G.R.

**ADVANCED**  
 ENGINEERING & DESIGN, INC.  
 CIVIL • MUNICIPAL • SITE DESIGN • PERMITTING • PLANNING  
 3931 68TH AVENUE NORTH • PINELLAS PARK, FL 33781 • Phone: 727.526.9158 • Fax: 727.527.9683

**CITY OF SEMINOLE**  
**BLOSSOM LAKE PARK IMPROVEMENTS**

**GENERAL DETAILS**

DATE: 12/14/2021  
 PROJECT NO: 21.SEM-15  
 SHEET NO: **C9**